

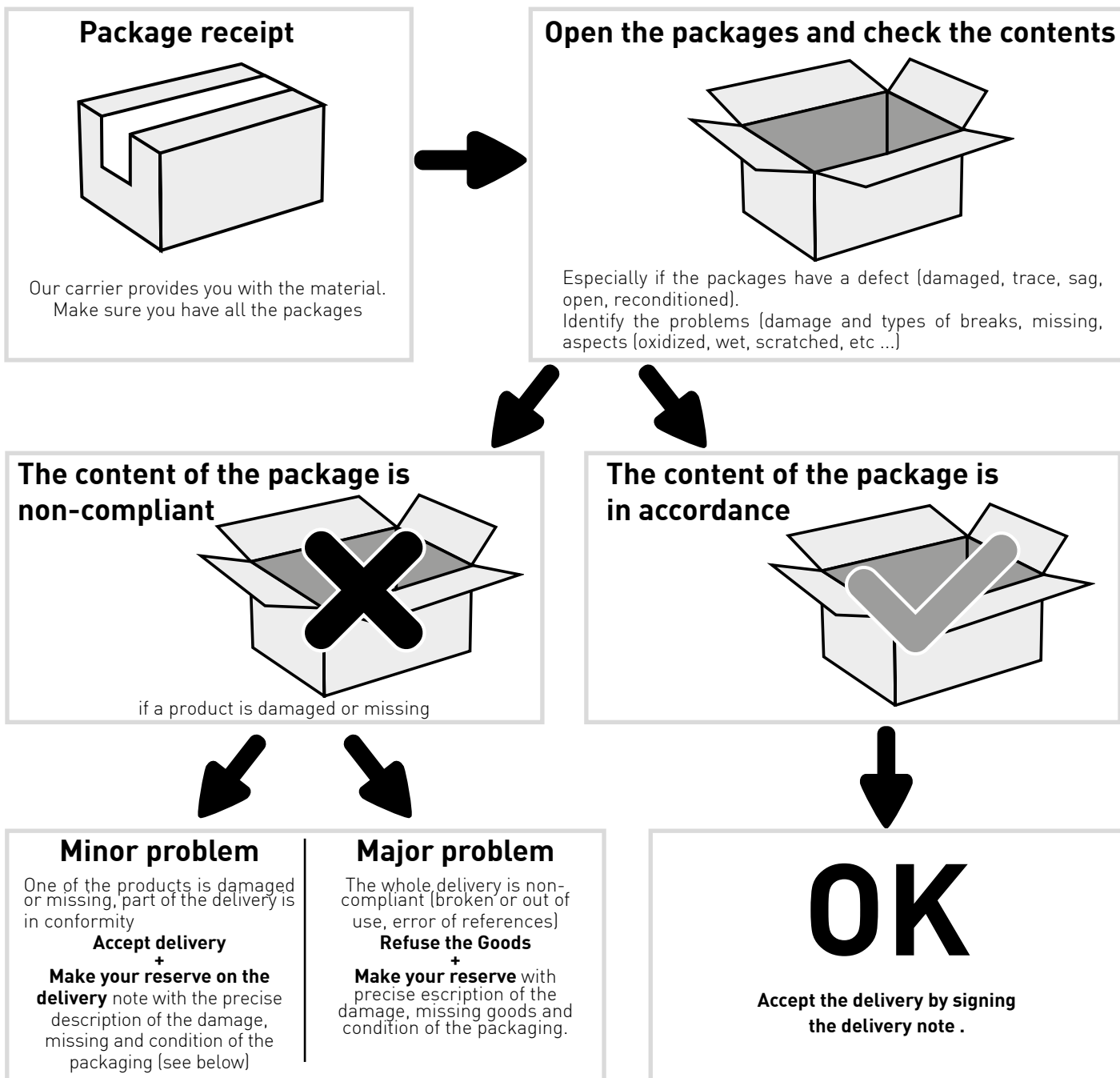

# Delivery check instructions

You have just received the material ordered from our company and we thank you. Despite all the attention paid to your order, a loss or degradation may have occurred during transport. Thank you for taking a few moments to make sure your delivery is compliant.

**This procedure is mandatory to support any claim.**



**Attention:** Before installation or use, the delivered products must be stored in their original packaging, under cover excluding any water or moisture, corrosive products, excessive heat or cold

## How to make your Reserves

